

CM-588

High Resolution

World's smallest color video camera

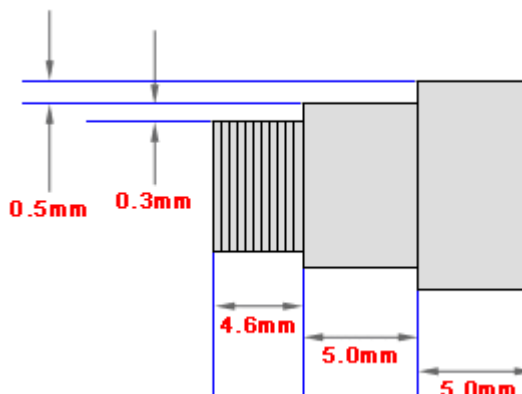

| Specifications |
|--|
| Image SENSOR ¼" COLOR CAMERA |
| Video System NTSC |
| Number of Effective Pixels 510X492(NTSC) |
| Scanning System 2:1 INTERLACE |
| Resolution 410 TV lines |
| S/N Ratio MORE THAN 48 dB |
| Minimum Illuminator 1.5 Lux at F1.2 |
| Electronic Shutter 1/50-1/63,000 sec |
| Horizontal Sync Frequency 15.734 kHz (NTSC) |
| Vertical Sync Frequency 60 Hz(NTSC) |
| Gamma Consumption 0.45 |
| Video Output 1 Vp-p. 75 ohms Composite |
| Audio Output 20-16000 Hz, S/N more than 58 dB (Optional) |
| Built-In Lens 3.5 mm/ F2.6 (STANDARD), 3.1 mm/ F3.4 (3T) |
| Storage Temperature -30 to 60 Degree C |
| Working Temperature -10 to 45 Degree C |
| Weight 2.5 g |
| Power Supply DC 7-12 V (Standard) or DC 6-10 V (Optional) |
| Power Current 35 mA (max.) |
| Dimensions (WXH) 8 mm x 8 mm x 14.6 mm only |
| |